

PRODUCT DESCRIPTION

V8516-01 CANINE HEAD-MOUNTED CAMERA “CRITTER VISION”

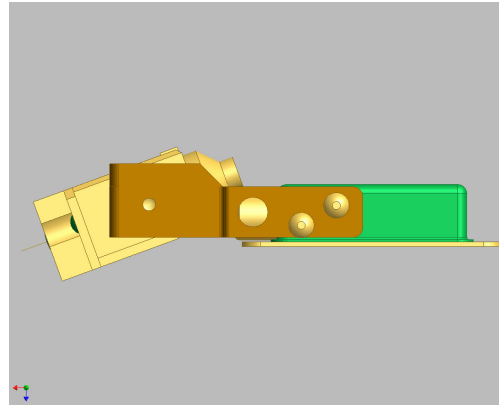
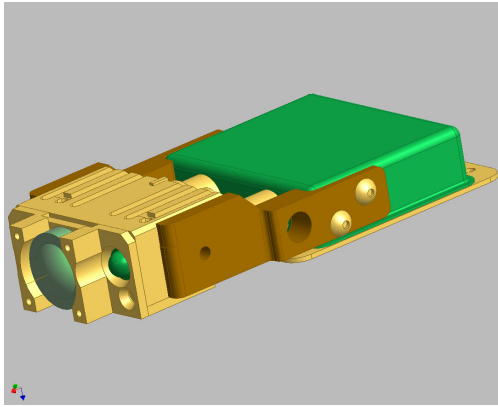

DESCRIPTION:

The V8516-01 Camera forms part of the VES/XTVision range of body-worn cameras and associated video equipment for Professionals in the field of Search/Rescue and Extreme Sports activities.

Using a ¼ in. CCD of 500 pixels per line, it provides the ideal balance between resolution, power consumption and sensitivity required for this type of application. In addition, the small size of sensor allows the overall height of the unit to be kept low to minimise the risk of impact when operating in confined spaces.

Mechanically, the unit is comprised of two sections linked by machined brackets which provide both support and rotation adjustment to suit the profile of the head or protective helmet. The front section is a sealed machined rectangular housing containing the lens and imaging sensor, two high-power LEDs and a light level sensor. The structure is sealed and designed to provide heatsinking for the LEDs and mechanical protection for the fixed-iris lens.

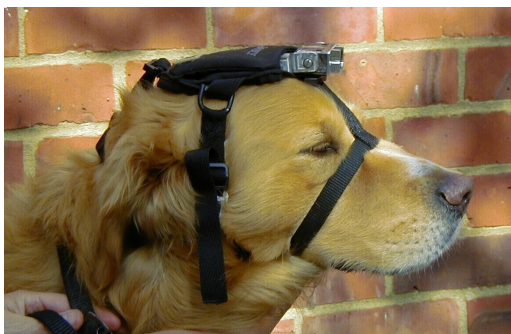

The sealed rear section contains drive electronics for the camera, a power supply for the camera and a 2W current-controlled supply for the LEDs. A lighting control module automatically turns the lighting on when required. The low height allows this section to be inserted into a soft pouch or other padded fabric based construction such as a modified ‘Halti’ dog collar.

The unit is intended to be connected to one of two items of equipment, either a realtime video transmitter with encryption for direct, line-of-sight communications, or a solid-state recorder for event logging purposes. Validation of the images captured can be achieved by fitting the V8438 GPS Data Overlay Unit, which also provides current position information on-screen.

Basic Specification:

Supply:	8-15V
Current:	at nominal 12V: 300mA, 3.6W Lighting ON, 100mA OFF.
Video output:	Composite PAL colour 1V pk-pk +-20% into 75 ohm
Resolution:	330H, 400V min. Central Area at full illumination
Sensitivity:	3lux at F2.0 min.
S/n ratio:	46dB, AGC off
AGC	0 to 15dB approx.
ELC	1/50 to 1/96000 range
White Bal	ATW
Lens	2.5mm f2.0
Viewing angle	approx 70H x 52V including lighting
Adjustment:	approx 45 degrees each direction
Lighting:	2 x 1W high radiance emitters colour temp: 5500K
Cables:	Flying leads to external power and video input
Dimensions:	V8516-01 o/all 101 x 52 x 18 Camera: 39 x 25 x 18 Control unit: 51 x 56 x 13.5
Weight:	approx 100g excluding harness.
Temp range:	-10 to +40C
Humidity	40 – 100 % incl. Short-term immersion.

Copyright 2005 Vision Engineering Services Ltd.

Supplied by:	Vision Engineering Services Ltd. UK
Phone/Fax:	44-1252-674941
Email:	enquiries@ves-eng.co.uk
Web:	www.ves-eng.co.uk